

11

10

9

8

7

6

5

4

3

2

1

POLE	HP	kW	Hz	VOLT	r/min (RPM)	INS	RATING	DIMENSIONS IN	APPROX WEIGHT	BEARINGS
2	125	93	60	230/460	3600	F	CONT.	INCHES	12721bs	DE: 6314C3 NDE: 6314C3

TOTALLY ENCLOSED FAN-COOLED TYPE, SQUIRREL-CAGE ROTOR

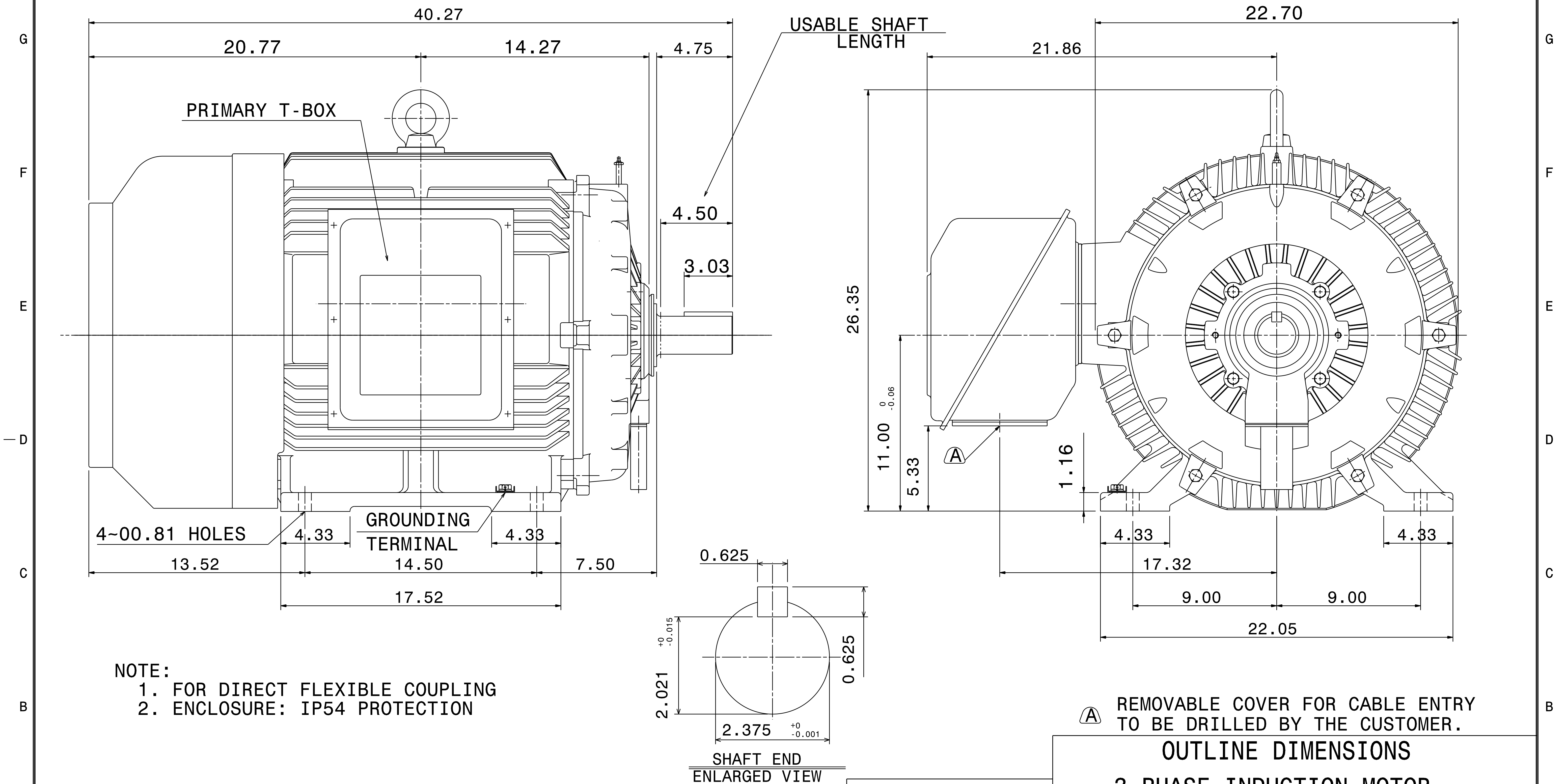

NOTE:  
1. FOR DIRECT FLEXIBLE COUPLING  
2. ENCLOSURE: IP54 PROTECTION

A REMOVABLE COVER FOR CABLE ENTRY  
TO BE DRILLED BY THE CUSTOMER.

OUTLINE DIMENSIONS  
3-PHASE INDUCTION MOTOR

MOTOR TYPE	AEHH8P	FRAME NO.	444TS
CATALOG#	NP1252	DATE	MARCH. 5, 2020
ORDER NO.		TRANS. SHEET	.

APPD.	BEN.YANG	04.08.19
CHKD.	K.L.KUO	04.08.19
DWG.	K.L.KUO	02.12.19

TEC Westinghouse

DWG NO.  
31057C523181

1	06.13.19	Show approx weight	K.L.KUO
---	----------	--------------------	---------